

To access the NMR data acquired from any of the NMR spectrometers

To access via J:\ResearchData\FWN\LIC\NMR_DATA

To access this path, special permission is needed from ISSC

PhD student has to request access for your Bachelor's/Master's student

Login to helpdesk portal and follow the steps given below

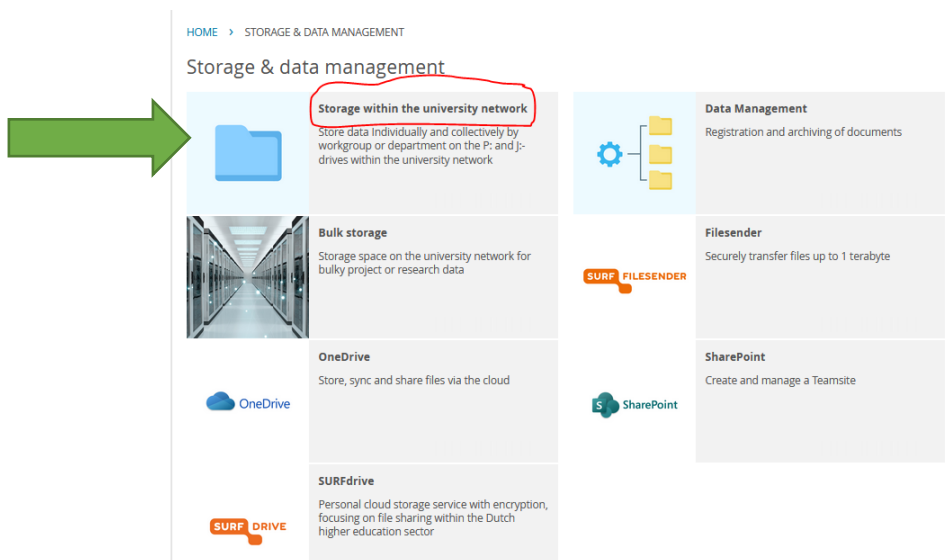
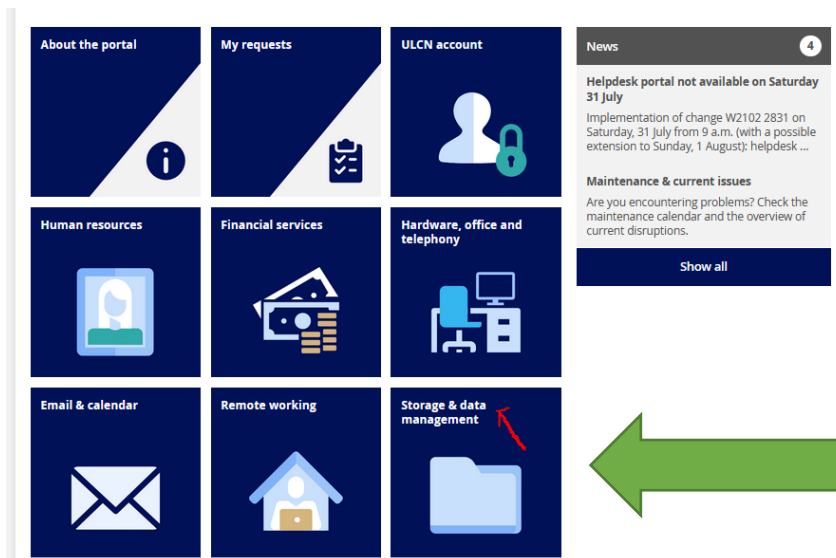

Storage within the university network

Store data Individually and collectively by workgroup or department on the P: and J:-drives within the university network

Personal

University staff have a personal storage space (P:-drive) of 50GB by default. If this is not sufficient, you can request enlargement of your personal storage space. Users of a Linux workstation have a [Linux home directory](#) in addition to the personal directory. You can [restore](#) backups of files yourself and request to [restore older data](#).

Department

In addition to individuals, departments also have their own storage space on the J:-drive. Employees are automatically granted access to the appropriate department folder(s) upon hire. Faculties and units can make their own choices when it comes to authorization for departmental folders. Your ICT

Request or change workgroup >

Request data recovery >

Increasing personal storage >

Request Linux home directory >



Authorisation

Authorisation by: *

ICT-contactperson FWN-LIC-NMR, >



Information on workgroup

Request: *



- New workgroup
- Change access to workgroup
- Remove workgroup

The requestor of a workgroup will automatically be the owner of the workgroup. Only the owner can request deletion of the workgroup. Members of a workgroup can only grant access to colleagues on the same level or lower. Your ICT-contact person eventually authorizes all requests.

PLEASE NOTE: If you also want access to the workgroup as an applicant, do not forget to mention your own ULCN username in the fields below.

Name workgroup: *

J:\ResearchData\FWN\LIC\NMR_DATA



Read only access (ULCN usernames or e-mail addresses):

Fill your students email username or email-ID



Additional information

Comments:

This is needed for research project.



Bachelor's/Master's student should request ISSC for an additional ssh login functionalities.

Visit this page:

<https://www.staff.universiteitleiden.nl/ict/help-and-support/application-forms/application-forms>

Under “Workplace and Software”

Choose: “[Request access SSH-gateway](#)”

Workplace and software	
Request software	Request software on your workplace
Request a 'semi-managed' (open) workplace	Self-manage your workplace, with limited ISSC support
Request no shut down	Prevent daily automatic shutdown & restart of your workplace
Request for remote desktop connection	Remote access to your physical Windows workplace
Request for change of operating system	Request another operating system on your workplace PC
Request access SSH-gateway 	Access (Linux terminal) servers on university network via SSH
Request new language settings for Microsoft Office (request by email)	Request an other interface or proofing language then the ones currently supported. Frequently requested language packs will be made available for self install

After you login with your student number id's

[HOME](#) > [SSH ACCESS](#) > [SSH ACCESS](#)

SSH access

[Frequently Asked Questions](#)

[Linux workplace](#)

Question: What possibilities does a Linux w...

Caller

Institute / Department *

Leiden Institute of Chemistry



Faculty / Expertise center *

Faculteit Wiskunde en Natuurwetenschappen



Request

Access to a specific server is desired: *

Yes
 No

If you need access to a server other than a Linux Terminal Server, you can enter the name and IP-address of that server below. With this data the ISSC can assess whether SSH access is possible.

Additional information

Comments:

I would like to access the research data
J:\ResearchData\FWN\LIC\NMR_DATA\
Thanks



* Required fields

Submit



J:\ResearchData\FWN\LIC\NMR_DATA\

Please give "Read only" access to this location

Thanks

Click, "submit"

Make sure your account

1. Could reach “J:\ResearchData\FWN\LIC\NMR_DATA\”
2. Could do ssh to “sftpgw.leidenuniv.nl”

Method-1

- 1) Start eduvpn app and sign-in
- 2) Open the windows explorer go to this below give location
\\spfss15.vuw.leidenuniv.nl\bulk_fwn_lic_nmr_data\$\all_nmr_data

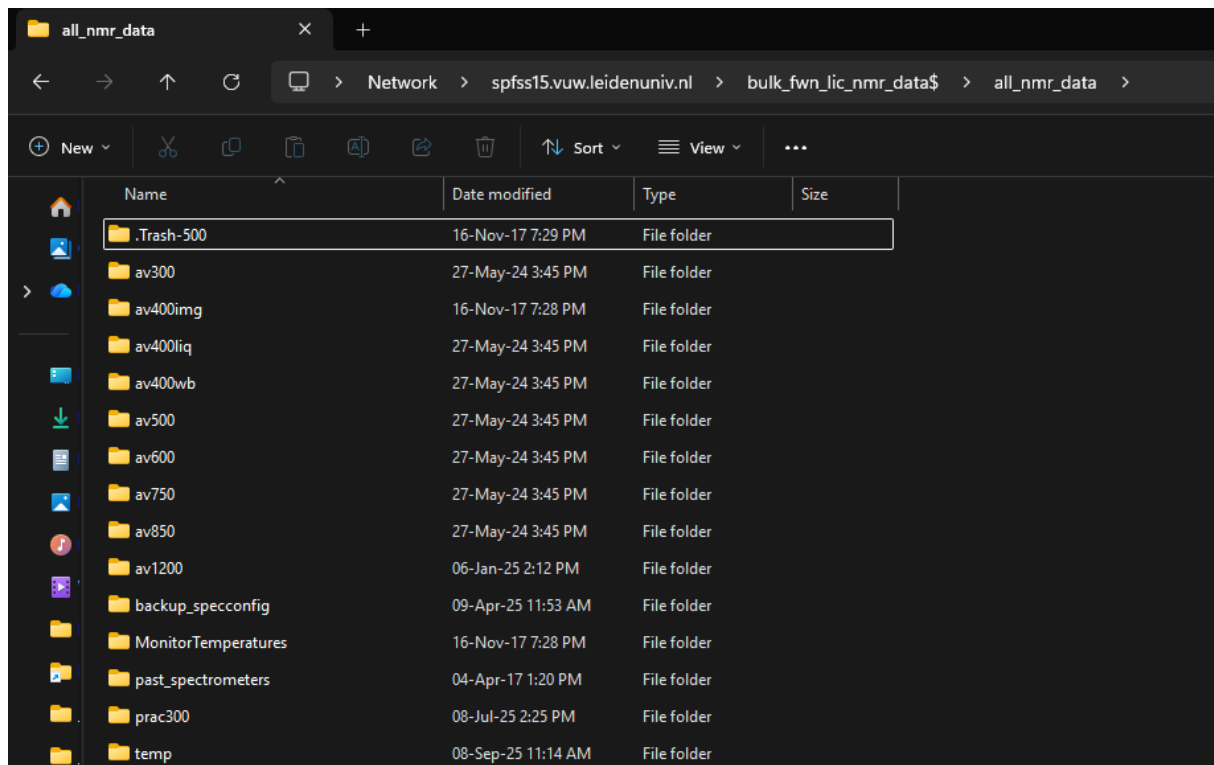

Method-2

Download any software with sftp functionalities.

1. WINSCP (<https://winscp.net/eng/index.php>)
2. CyberDuck (<https://cyberduck.io/>)

Hostname : sftpgw.leidenuniv.nl
Port: 22
Username: Username starting with snumbers
Password : *****

Working steps:

On one side, it is the path required for the local computer (destination where the data has to be copied), while on another side, you need to reach the NMR data location through this path
/vol/winshare/Public/ResearchData/FWN/LIC/NMR_DATA/all_nmr_data/

Examples of the path :

C:\Users\NMRdata\ (choose your path local computer)

For 300 NMR data :

/vol/winshare/Public/ResearchData/FWN/LIC/NMR_DATA/all_nmr_data/av300/data/nmrafd
/nmr

For AV-400-liq NMR data

/vol/winshare/Public/ResearchData/FWN/LIC/NMR_DATA/all_nmr_data/av400liq/data/nmr
afd/nmr

Time-saving tips to reach the data easily:

- After the first time, please look for the option “save workspace” or “Bookmark”