

To access the NMR data acquired from any of the NMR spectrometers

To access via J:\ResearchData\FWN\LIC\NMR_DATA

To access this path, special permission is need from ISSC

PhD student has to request access for your Bachelor's/Master's student

Login to helpdesk portal and follow the steps given below

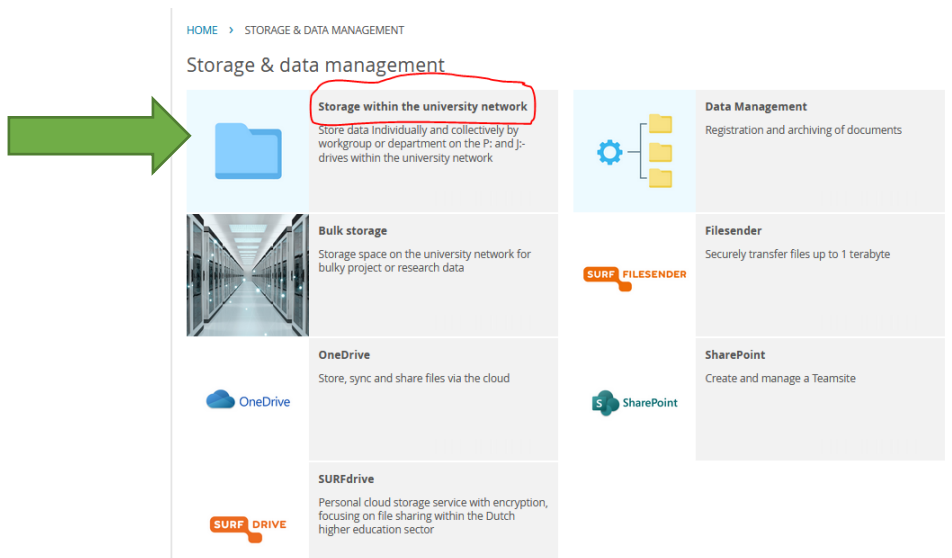
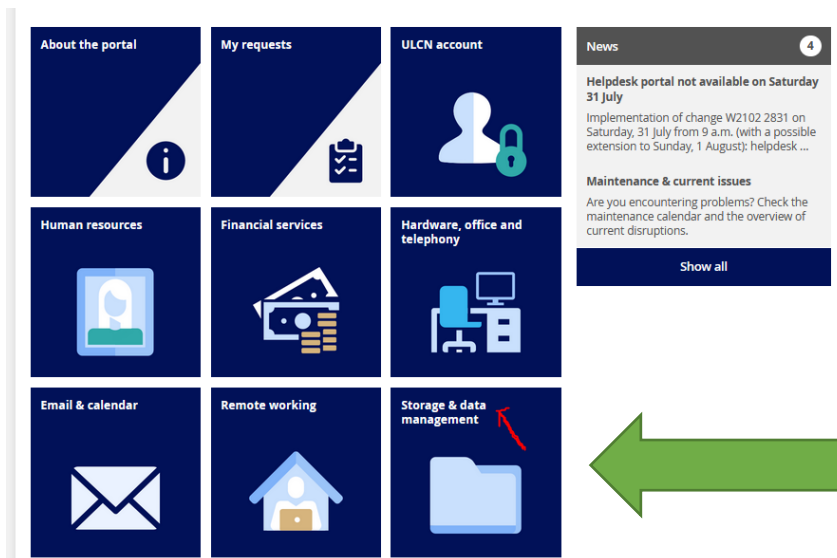

Storage within the university network

Store data Individually and collectively by workgroup or department on the P: and J:-drives within the university network

Personal

University staff have a personal storage space (P:-drive) of 50GB by default. If this is not sufficient, you can request enlargement of your personal storage space. Users of a Linux workstation have a [Linux home directory](#) in addition to the personal directory. You can [restore](#) backups of files yourself and request to [restore older data](#).

Department

In addition to individuals, departments also have their own storage space on the J:-drive. Employees are automatically granted access to the appropriate department folder(s) upon hire. Faculties and units can make their own choices when it comes to authorization for departmental folders. Your ICT

Request or change workgroup >

Request data recovery >

Increasing personal storage >

Request Linux home directory >



Authorisation

Authorisation by: *

ICT-contactperson FWN-LIC-NMR, ▾



Information on workgroup

Request: *



- New workgroup
- Change access to workgroup
- Remove workgroup

The requestor of a workgroup will automatically be the owner of the workgroup. Only the owner can request deletion of the workgroup. Members of a workgroup can only grant access to colleagues on the same level or lower. Your ICT-contact person eventually authorizes all requests.

PLEASE NOTE: If you also want access to the workgroup as an applicant, do not forget to mention your own ULCN username in the fields below.

Name workgroup: *

J:\ResearchData\FWN\LIC\NMR_DATA



Read only access (ULCN usernames or e-mail addresses):

Fill your students email username or email-ID



Additional information

Comments:

This is needed for research project.

